



# PORT OF OAKLAND

## NOTICE OF HEARING

FOR

**Oakland Airport Business Park  
Approval of Variance from the Parking Standards  
8399 Edgewater Drive, Oakland, CA**

**Project Applicant:** Traffic Management, Inc.

**Project Location:** The project is located in the Oakland Airport Business Park in Oakland, California. The site is located on a corner lot with current access driveway to Edgewater Drive, and no driveway from Pendleton.

**Project Description:** The project applicant proposes to make improvements in front of their buildings along Edgewater Drive and Pendleton Way to add parking spaces. A portion of the work is proposed within the front setback area, and would exceed the maximum coverage for parking. The proposed work includes a new driveway onto Pendleton, and sidewalk and landscape improvements.

**Public Hearing:** A hearing will be held at 1:00 pm on Tuesday, August 1, 2017 at the Port offices located at 530 Water Street. Evidence will be documented, testimony will be heard, and a decision will be made regarding the following variance request:

Application for variance from the Land Use and Development Code (LUDC), Section 3.5.A for exceeding the maximum front setback area occupied by parking and circulation.

The Port Executive Director's designated Public Hearing Officer (Richard Sinkoff, Director of Environmental Programs and Planning) will preside over the hearing and make a decision based on the evidence presented. A full written report with the Permit Coordinator's recommendation will be posted to the Port's website by Wednesday, July 26 (found at [www.portoakland.com/business/bids-rfps/bid-engineering/permits/](http://www.portoakland.com/business/bids-rfps/bid-engineering/permits/)).

**Appeal:** The decision may be appealed to the Board of Port Commissioners per the procedures in the LUDC, Section 5.7, and must be filed within 14 days after the Notice of Decision. The Notice will be filed within 24 hours of the close of the hearing. Any appeals must be based on evidence presented to the Port prior to or at the hearing.

**For More Information:** Joe Marsh, Permit Coordinator, Port of Oakland, 2<sup>nd</sup> Floor, 530 Water Street, Oakland, CA 94607. [jmarsh@portoakland.com](mailto:jmarsh@portoakland.com)

APN: 042-4425-009-00

**PENDLETON WAY**  
60' W/M

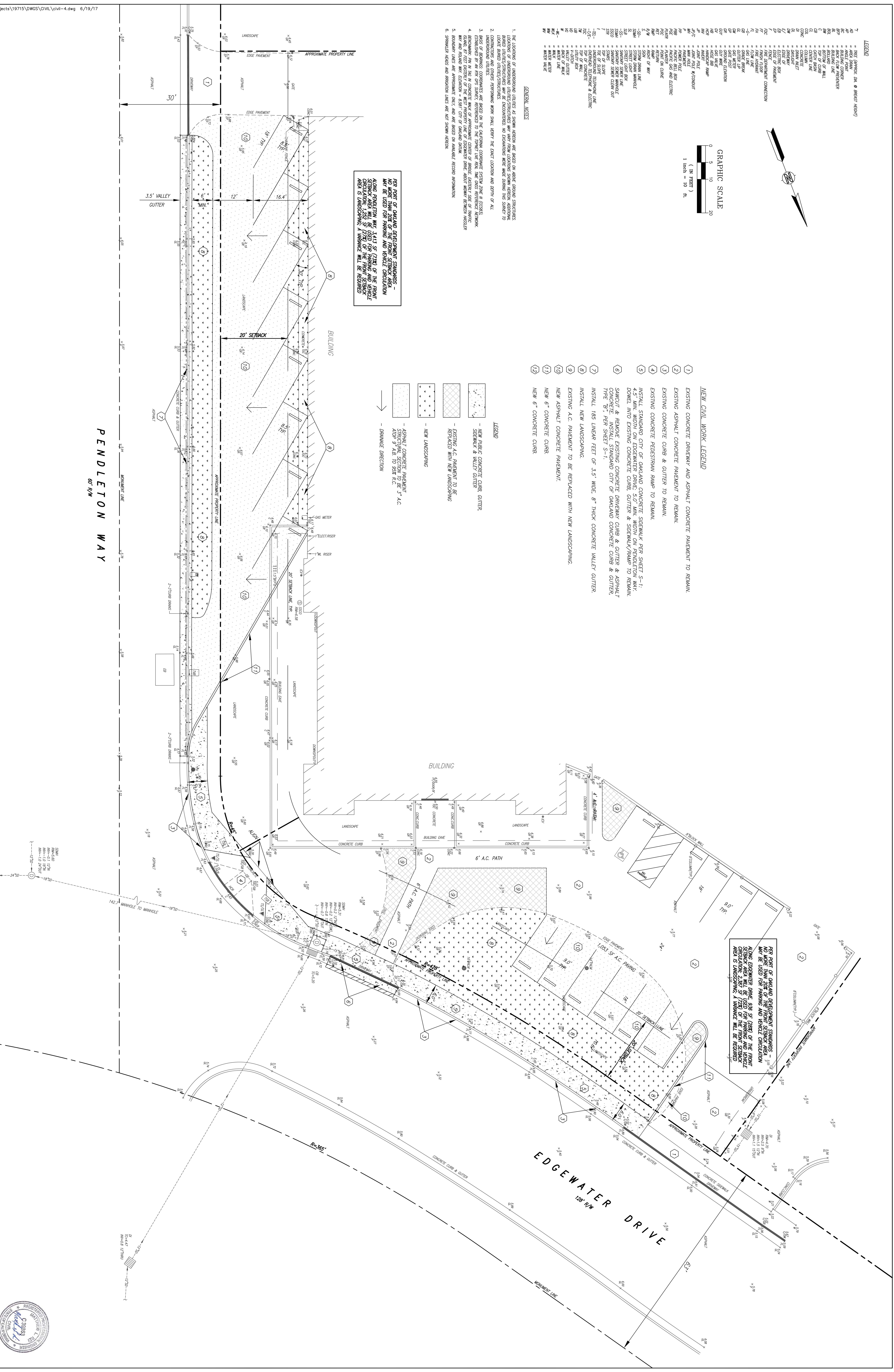

- LEGEND**
- 1- 1" = 10' (AS SHOWN)
  - 2- 1" = 10' (AS SHOWN)
  - 3- 1" = 10' (AS SHOWN)
  - 4- 1" = 10' (AS SHOWN)
  - 5- 1" = 10' (AS SHOWN)
  - 6- 1" = 10' (AS SHOWN)
  - 7- 1" = 10' (AS SHOWN)
  - 8- 1" = 10' (AS SHOWN)
  - 9- 1" = 10' (AS SHOWN)
  - 10- 1" = 10' (AS SHOWN)
  - 11- 1" = 10' (AS SHOWN)
  - 12- 1" = 10' (AS SHOWN)

- NEW CIVIL WORK LEGEND**
- 1 EXISTING CONCRETE DRIVEWAY AND ASPHALT CONCRETE PAVEMENT TO REMAIN.
  - 2 EXISTING ASPHALT CONCRETE PAVEMENT TO REMAIN.
  - 3 EXISTING CONCRETE CURB & GUTTER TO REMAIN.
  - 4 EXISTING CONCRETE PEDESTRIAN RAMP TO REMAIN.
  - 5 REMOVE & REPAIR EXISTING CONCRETE DRIVEWAY CURB & GUTTER & ASPHALT TYPE 185 PER SHEET S-1.
  - 6 REMOVE & REPAIR EXISTING CONCRETE DRIVEWAY CURB & GUTTER & ASPHALT TYPE 185 PER SHEET S-1.
  - 7 INSTALL 185 LINEAR FEET OF 3.5' WIDE, 8" THICK CONCRETE VALLEY GUTTER.
  - 8 INSTALL NEW LANDSCAPING.
  - 9 EXISTING A.C. PAVEMENT TO BE REPLACED WITH NEW LANDSCAPING.
  - 10 NEW ASPHALT CONCRETE PAVEMENT.
  - 11 NEW 6" CONCRETE CURB.
  - 12 NEW 6" CONCRETE CURB.

FOR PORT OF OAKLAND DEVELOPMENT STIMULUS -  
FOR MORE THAN ONE OF THE FRONT SIDEWALK AREAS  
MAY BE USED FOR PARKING AND VEHICLE CIRCULATION  
ALONG PENDLETON WAY 1413 S (288) OF THE FRONT  
SIDEWALK AREA WILL BE USED FOR PARKING AND VEHICLE  
CIRCULATION. 1202 S (278) OF THE FRONT SIDEWALK  
AREA IS UNDESIRABLE FOR PARKING AND VEHICLE  
CIRCULATION AND WILL BE REMOVED.

- LEGEND**
- NEW ASPHALT CONCRETE CURB, GUTTER, SIDEWALK & VALLEY GUTTER
  - EXISTING A.C. PAVEMENT TO BE REPLACED WITH NEW LANDSCAPING
  - NEW LANDSCAPING
  - ASPHALT CONCRETE PAVEMENT STRUCTURAL SECTION TO BE 3" A.C. AOP 9' A.B. TO 558 R.C.
  - DRAINAGE DIRECTION

FOR PORT OF OAKLAND DEVELOPMENT STIMULUS -  
FOR MORE THAN ONE OF THE FRONT SIDEWALK AREAS  
MAY BE USED FOR PARKING AND VEHICLE CIRCULATION  
ALONG PENDLETON WAY 936 S (288) OF THE FRONT  
SIDEWALK AREA WILL BE USED FOR PARKING AND VEHICLE  
CIRCULATION. 1202 S (278) OF THE FRONT SIDEWALK  
AREA IS UNDESIRABLE FOR PARKING AND VEHICLE  
CIRCULATION AND WILL BE REMOVED.

<p>FIELD BOOK NO. _____</p> <p>TITLE SHEET _____</p> <p>PROJECT NO. _____</p> <p>DRAWN BY _____</p> <p>CHECKED BY _____</p> <p>DATE 6/19/17</p>	<p>REFERENCES</p> <p>REVISIONS</p>	<p><b>KISTER SAVIO &amp; REI, INC.</b> LAND SURVEYORS - CIVIL ENGINEERS 825 SAN RAFAEL AVENUE PUNICOLE, CALIFORNIA 94564 PHONE: (916) 222-4050 FAX: (916) 222-3718 E-MAIL: INFO@KSREI.COM</p> <p>DATE: 6/19/17</p>	<p>DESCRIPTION</p> <p><b>PARKING IMPROVEMENT PLAN</b></p> <p>APN: 042-4425-009</p> <p>CALIFORNIA</p>
-------------------------------------------------------------------------------------------------------------------------------------------------	------------------------------------	----------------------------------------------------------------------------------------------------------------------------------------------------------------------------------------------------------------------------------------	------------------------------------------------------------------------------------------------------

